

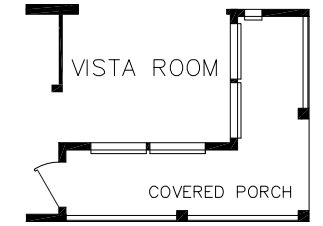

# Craftsman

## WC-28

Approx. 1727 SQ. FT.  
(1859 SQ. FT. INCLUDING PORCH)



OPT. VISTA ROOM

This beautiful Craftsman Style home features three Bedrooms and two Baths along with a wrap around front corner Porch. Vaulted ceilings accented with raised volume ceilings in selected areas and architectural detailing are standard throughout the interior living spaces. The huge island Kitchen opens to the Dining Room and Porch. An optional two sided fireplace separates the Dining and Living Rooms. Luxury, style and convenience define the Kitchen and Master Bath. Silvercrest's flexibility allows you to custom tailor this home to suit your personal needs.

